

Proposal for the EMCal of ZDC

Kai-Yu Cheng, Chia-Ming Kuo, Shao-Yang Lu
National Central University, Taiwan

Chih-Hsun Lin
Academia Sinica, Taiwan

SiPM size

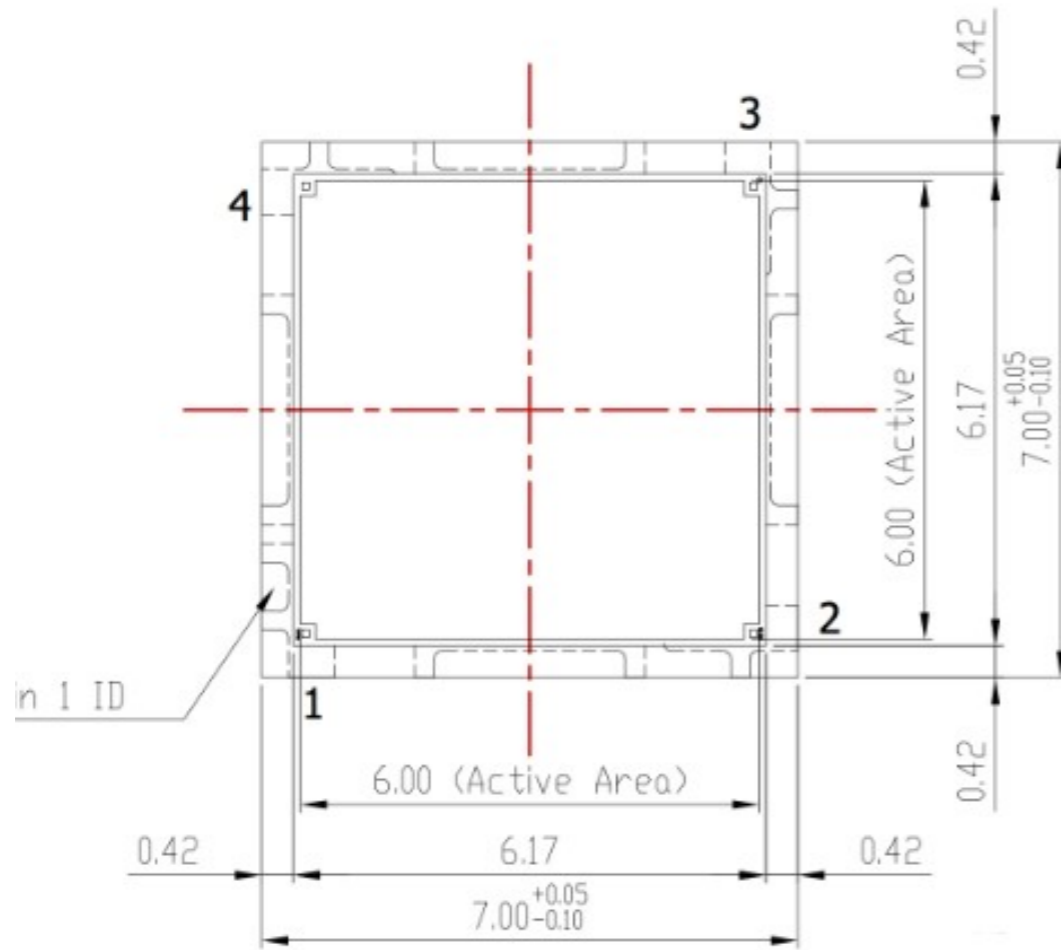

TOP VIEW

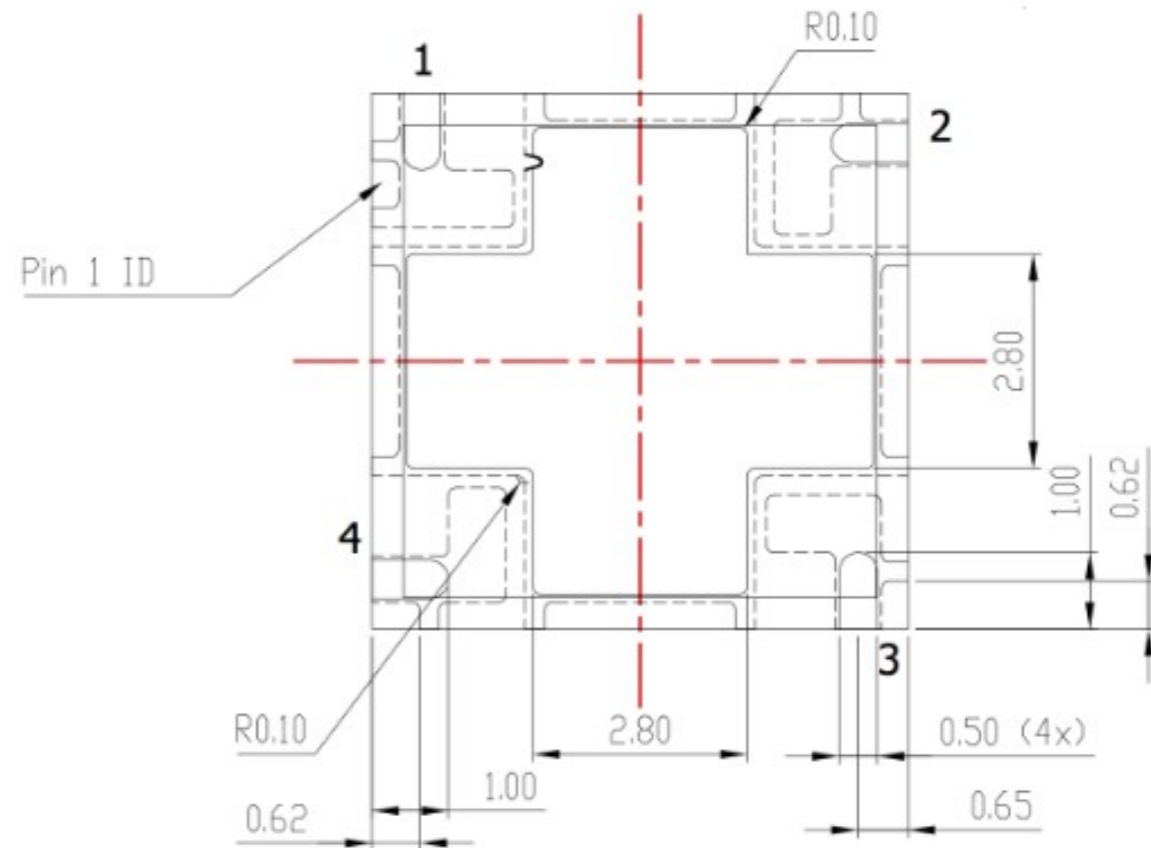

BOTTOM VIEW

Active area: 6mm x 6mm
Total area: 7mm x 7mm

Front face cross-section of LYSO crystals

- thickness of 3M ESR and optical adhesive: 80 μ m

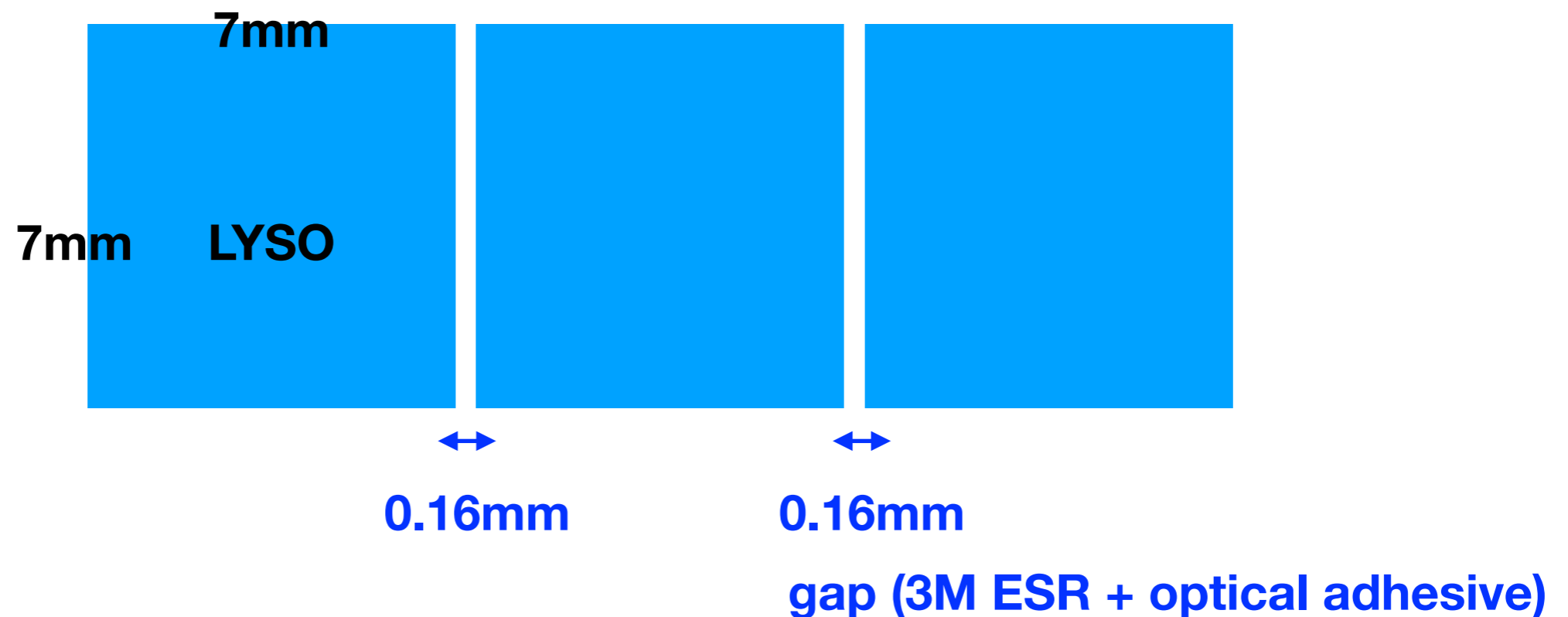

Geant4 simulation

Edep_ch11224

